

COLAZIONE A BARRIERA 2021

CURATED BY SERGEY KANTSEDAL
WITH THE ASSISTANCE OF YULIYA SAY

WHO SAVES US

LUCA BERTOLO

SPECIAL GUEST: CHIARA CAMONI

TEXT BY ANTONIO GRULLI

*Actually yes, actually maybe not,
Poetry will change the world a little bit.
But through so much time,
Yes, I can feel it
That through poetry
there will be
Change
But like snow fall
ever, ever more slowly.
Vivian Lamarque*

WHO SAVES US includes three monumental papers portraying childish superheros, three small paintings of pharmaceutical packagings, a big canvas and a banner with challenging slogans, an existentialist sound installation, the oil painting of a stuffed animal and a magical steel and wooden object. A few unique ceramic plates by Chiara Camoni are set on a silk tablecloth stained with wild plants to complete the exhibition.

The catalogue, designed by CCN Studio (Lia Cecchin), will be presented at the opening.

Luca Bertolo (1968, Milano, IT) attended the Graduate Degree Course in Information Technology from 1987 until 1992 at Milano Università Statale, where he began writing his thesis on Mathematical Logic while taking other courses in art and working as an illustrator. Following a period of residence in London, he returned to Italy and graduated from the Brera Fine Arts Academy in 1998. He moved to Berlin the same year, where he lived until 2005. The artist currently lives in a small village in Tuscany and teaches painting at the Academy of Fine Arts in Bologna.

Recent solo shows include: *Why Write? Why Paint?*, SpazioA, Pistoia; Luca Bertolo, at MART, Rovereto, IT; *Se non qui dove (If not Here, Where?)*, organized by MAN, Gavoi, Ex Caserma, Nuoro, IT; *Everybody is always right*, Arcade, London, UK; *If Anything*, Marc Foxx Gallery, Los Angeles, USA; *A Painting Cycle*, curated by Cecilia Canziani and Ilaria Gianni, Nomads Foundation, Roma, IT. Recent group exhibitions include: *Sul principio di contraddizione (On the principle of contradiction)*, curated by E. Volpato, GAM, Torino, IT; *Citoyenne Reprise*, collective project curated by Jeremiah Day, Network Aalst, Aalst; *Le realtà ordinarie*, curated by Davide Ferri, Banca di Bologna, Bologna, IT; *Iconoclasm. Il conflitto delle immagini*, curated by Antonio Grulli, Diego Bergamaschi, Marco Martini, Museo di Castelvecchio, Verona, IT; *Material Life*, The Goma, Madrid, ES; *Recto Verso*, Fondazione Prada, Milano, IT; Anna Barham, Luca Bertolo, John Wallbank, Galerie Tatjana Pieters, Gent, BE; *Souvenir*, curated by Lucie Fontaine, Galerie Perrotin, Paris, FR; *Fig. 2: Natura Morta*, curated by Cecilia Canziani and Ilaria Gianni, GNAM, Roma, IT.

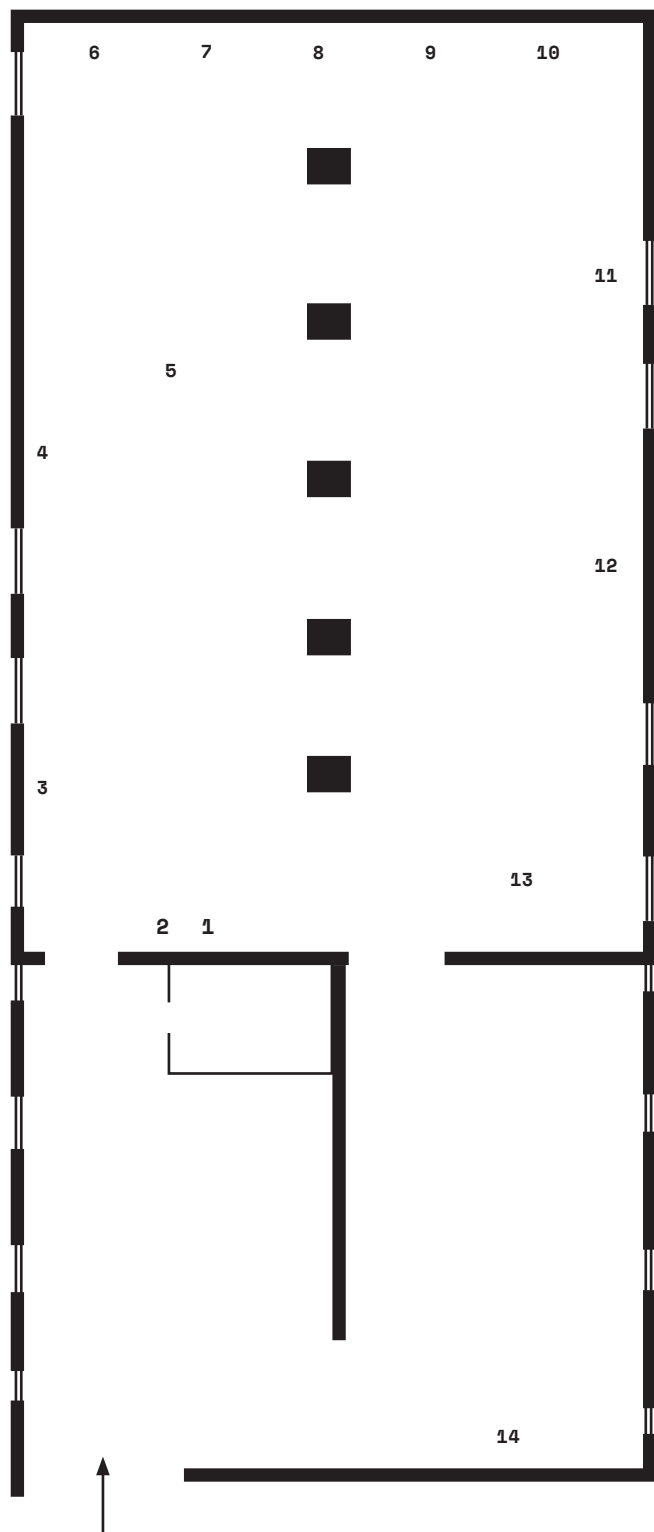

- 1 *me #2*, 2006, oil and acrylic on canvas, 30 x 35 cm.
- 2 *me #4*, 2006, oil and acrylic on canvas, 30 x 35 cm.
- 3 *me #3*, 2006, oil and acrylic on canvas, 30 x 35 cm.
- 4 *Peluche #1*, 2020, oil on canvas, 50 x 40 cm.
- 5 *Piatti*, 2021, stoneware glazed with soil, sand and ashes, vegetal print on silk, variable dimensions.
- 6 *Sergeant Zeno's Task Force*, 2018, water mixable oil colors on paper, 190 x 150cm.
- 7 *Sergeant Zeno's Task Force*, 2018, water mixable oil colors on paper, 190 x 150cm.
- 8 *Sergeant Zeno's Task Force*, 2018, water mixable oil colors on paper, 190 x 150cm.
- 9 *Sergeant Zeno's Task Force*, 2018, water mixable oil colors on paper, 190 x 150cm.
- 10 *Sergeant Zeno's Task Force*, 2018, water mixable oil colors on paper, 190 x 150cm.
- 11 *Prayer* (loop 4'40"), 2011, mp3
- 12 *Striscione (Banner) #2*, 2020, acrylic, oil and wallpaper on canvas, wood, 270 x 325 x 4 cm.
- 13 *Magic Device*, 2021, steel, wood, acrylic, wax, 190 x 148 x 40 cm.
- 14 *La Grazia*, 2020, acrylic on canvas, wood, iron, 217 x 175 cm.

Associazione Barriera is a space for contemporary art, founded in 2007 by a group of collectors in the neighborhood Barriera di Milano of Turin.

barriera

Via Crescentino 25, Torino
www.associazionebarriera.com
associazione.barriera.torino@gmail.com

Barriera is curated by Sergey Kantsedal.
 Assistant curator: Yuliya Say

IN COLLABORATION
 WITH SPAZIOA, PISTOIA

The activities of Barriera
 are supported by

**Fondazione
 CRT**